



DUAL INPUTS



BGM and Paging amplifier inputs for uninterrupted paging setup

application notes

ZS5602 is used when an uninterrupted paging setup is required. ie : when an announcement is made at a certain zone, other non paging zone shall not be interrupted, which would continue to listen to the broadcasted program.

Setting up such a configuration in a conventional system shall require two sets of amplifiers ; one being dedicated to Paging and the other to BGM. Other method shall be by assigning each zone to an amplifier, which may be costly. Matrix system shall not require this type of zone selector to achieve the purpose.

Similar to ZS5601 or ZS5121, it can be remotely triggered by remote paging console or zone selection decoder unit.

Each zone shall have individual input and output connections. thereby making it rather flexible for amp-zone configuration.

features

- Available in 6 zones for BGM and 6 for Paging and ALL CALL
- Expandable or link multiple units to form more zones
- Remote zone triggering port via external paging mic
- Emergency paging mic triggering port with dry contact for volume controller overriding application
- Flexible amplifier - zone configurations with dual inputs (BGM and Paging)
- Aux DC output for selected paging zone
- Suitable for 3 or 4 wire system

specifications

Operating voltage	24V DC ; 1A
Power consumption	10W ; 0.42 A at ALL CALL
Insertion loss	0.5 dB
Zone load rating	400W at 100V line
No of zones	6
No of amplifier inputs	6 BGM amps ; 6 Paging amps
BGM zone selection	Front panel switch
Paging zone selection	Front panel switch / remote triggering
Zone active indication	Front panel LED (individual zone)
Aux output voltage	24V DC; max 3A
Dimensions (W x H x D)	482 x 44 x 130 mm
Weight	2.0 kg

application schematic

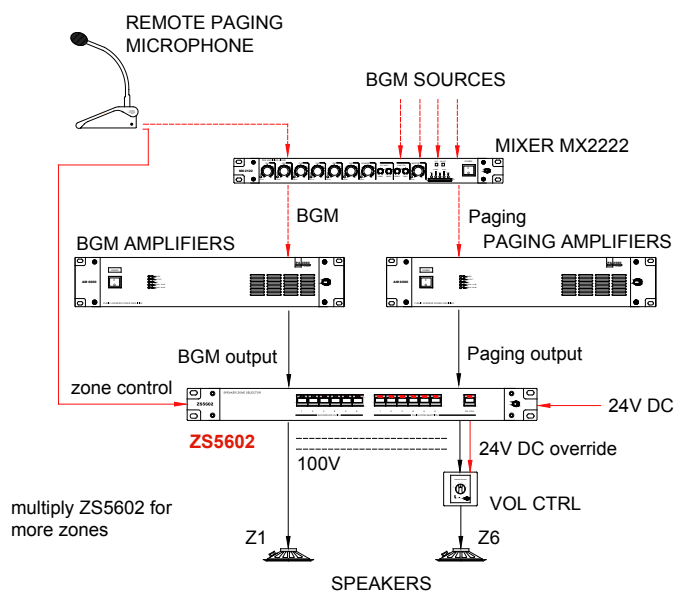

rear view

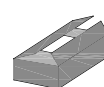
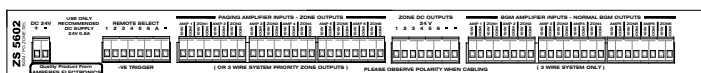

Packing information

Set Packing :
Qty / pack : 1 unit
W x H x D : 540 x 105 x 270 mm
Weight : 2.45 kg